

# F5802

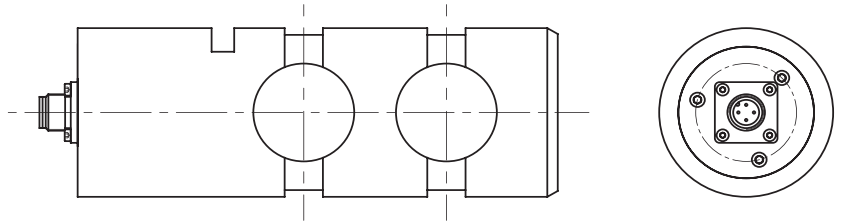

## Size and Capacity



Note: Dimensions acc customer requirement.



## Features & Applications

- Made of stainless steel, long term stability
- Used in overload tower cranes and hoisting cranes for prevention
- Can be used as replacement for existing shafts
- Used for port, terminal and cargo cranes as well as hoist, lifting equipment and safety testing applications
- Shape and size customized, IP67 protection

Capacity (kg)	Material
200~1000000	Stainless steel



## Load Direction

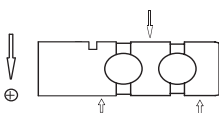

## Schematic Wiring Diagram

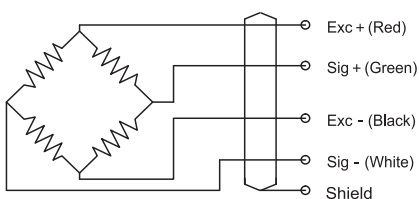

## Technical Parameters

Specifications	Technique
Rated output	1.0 ± 5% mV/V
Non-linearity	0.5% F.S.
Hysteresis	0.5% F.S.
Repeatability	0.5% F.S.
Temp. effect on output	0.2% F.S. / 10°C
Temp. effect on zero	0.2% F.S. / 10°C
Input impedance	750 ± 30 Ω
Output impedance	700 ± 5 Ω
Insulation	≥5000MΩ/100VDC
Recommended excitation	5~10V
Maximum excitation	15V
Compensated temp. range	-10 ~ 60°C
Operation temp. range	-20 ~ 80°C
Safe overload	150% F.S.
Ultimate overload	300% F.S.
Cable size	M12 × 1-4P
Protection class	IP67
Cable color code	Input: Red(+) Black(-); Output: Green(+) White(-);

Note: Cable shield is not connected to element.