

Size and Capacity

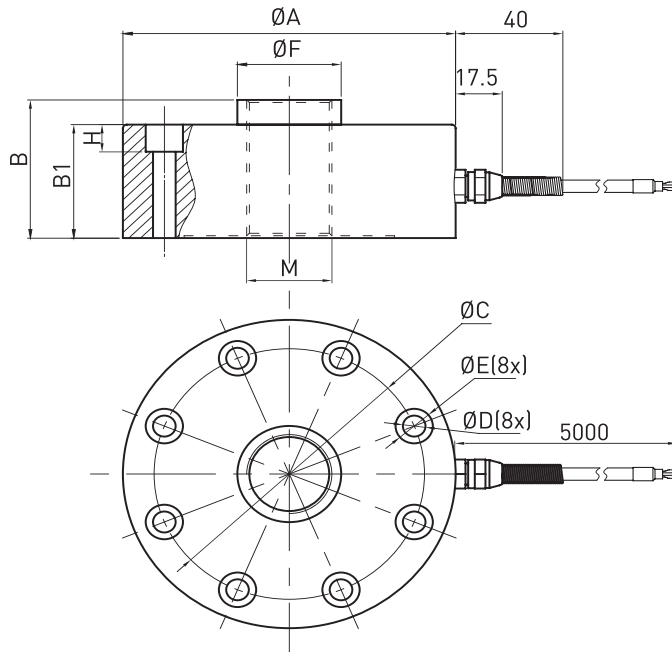

Features & Applications

- Pancake load cell made of alloy steel, internal amplifier optional
- Mainly used for warehouse scales, platform scales, truck scales, floor scales, railway scales, hopper scales and other measuring devices

| SIZE(mm) | A | B | B1 | C | D | E | F | H | M | Material | Weight |
|-------------|-----|----|----|-------|------|------|----|-----|---------|-------------|--------|
| 0.5/1/2/5/7 | 105 | 37 | 34 | 89 | 6.5 | 10.5 | 32 | 7.2 | M16*1.5 | Alloy steel | 1.8kg |
| 10/20/25 | 125 | 56 | 46 | 101.8 | 10.5 | 18 | 39 | 11 | M30*1.5 | | 4.5kg |
| 30/40/50 | 145 | 65 | 54 | 116.8 | 12.5 | 20 | 60 | 14 | M40*1.5 | | 7kg |

Technical Parameters

| Specifications | Technique |
|-------------------------|---|
| Rated output | 2.0 ± 1% mV/V |
| Zero balance | ± 1% F.S. |
| Non-linearity | 0.05% F.S. |
| Hysteresis | 0.05% F.S. |
| Repeatability | 0.03% F.S. |
| Creep (30min) | 0.05% F.S. |
| Temp. effect on output | 0.03% F.S. / 10°C |
| Temp. effect on zero | 0.03% F.S. / 10°C |
| Input impedance | 750 ± 10Ω |
| Output impedance | 700 ± 5Ω |
| Insulation | ≥5000MΩ / 100VDC |
| Recommended excitation | 10V |
| Maximum excitation | 15V |
| Compensated temp. range | -10 ~ 60°C |
| Operation temp. range | -20 ~ 80°C |
| Safe overload | 150% F.S. |
| Ultimate overload | 200% F.S. |
| Cable size | Ø5 × 5000 mm |
| Protection class | IP66 |
| Cable color code | Input: Red(+) Black(-); Output: Green(+) White(-); |

Load Direction

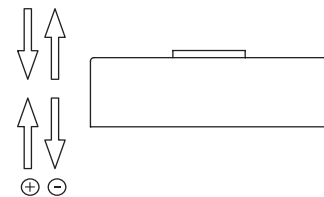

Schematic Wiring Diagram

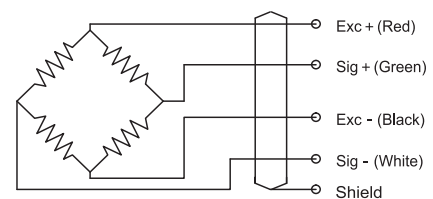

Note: Cable shield is not connected to element.