

F1818



Features & Applications

- Miniature load cell, low profile
- Made of stainless steel, IP64
- Suitable for force measurement in limited spaces
- Various applications such as consumer electronics assembly, automation industry

Size and Capacity

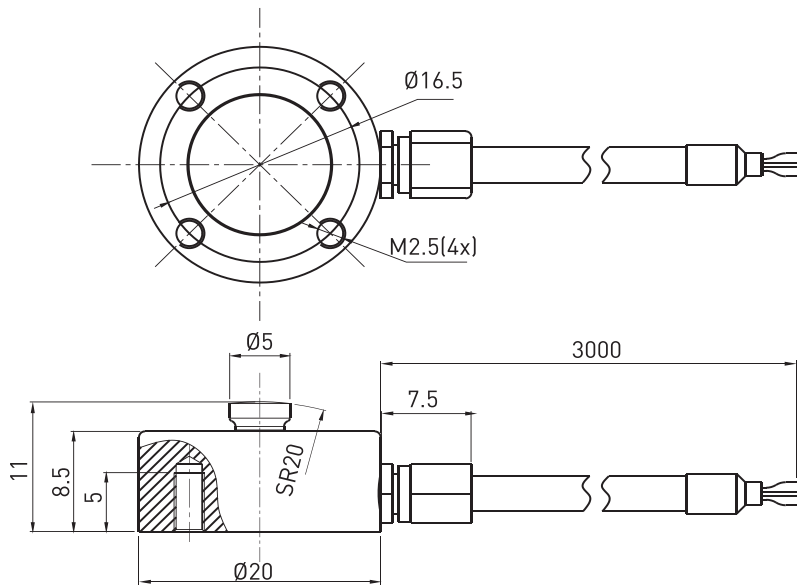

Capacity (kg)	Material	Weight
5/10/20/50/100/200/500/ 1000/1500/2000	Stainless steel	0.1kg

Load Direction

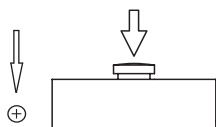

Schematic Wiring Diagram

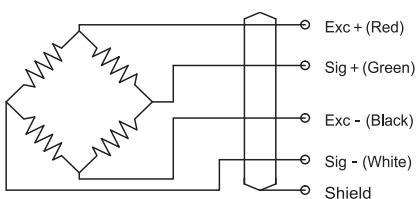

Note: Cable shield is not connected to element.

Technical Parameters

Specifications	Technique
Rated output	1.5 ± 10% mV/V
Zero balance	± 2% F.S.
Non-linearity	0.5% F.S.
Hysteresis	0.5% F.S.
Repeatability	0.1% F.S.
Input impedance	350 ± 10 Ω
Output impedance	350 ± 5 Ω
Insulation	≥5000MΩ / 100VDC
Recommended excitation	5V
Maximum excitation	10V
Operation temp. range	-20 ~ 80°C
Safe overload	150% F.S.
Ultimate overload	200% F.S.
Cable size	Ø2 × 3000 mm
Protection class	IP65
Cable color code	Input: Red(+) Black(-); Output: Green(+) White(-);